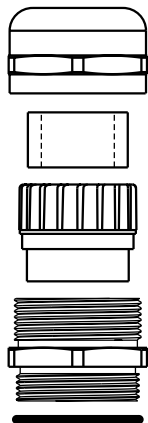
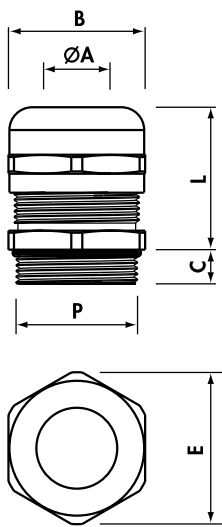

**COMPRESSION CABLE GLANDS NICKEL PLATED BRASS
MAXIBRASS 2900 SERIES - METRIC THREAD**

MAXIbrass® standard
Metric thread M 1.5 pitch CEI EN 60423 CEI EN 50262

| Ref. Nickel Plated Brass | P | Fixing Hole Ø (mm) | Ø A min-max (mm) | B Spanner (mm) | E (mm) | C (mm) | L min-max (mm) | Quantity |
|--------------------------|---------|--------------------|------------------|----------------|--------|--------|----------------|----------|
| 2900.M12N | M12x1,5 | 12,2 | 3 - 7 | 16 | 18 | 6,5 | 16-20 | 100 |
| 2900.M16N | M16x1,5 | 16,2 | 4,5-10 | 20 | 23 | 7,0 | 20-25 | 100 |
| 2900.M20N | M20x1,5 | 20,5 | 7 -13 | 24 | 27 | 8,0 | 20-27 | 50 |
| 2900.M25N | M25x1,5 | 25,4 | 10 -17 | 29 | 32 | 8,0 | 24-30 | 50 |
| 2900.M32N | M32x1,5 | 32,5 | 11 -21 | 36 | 40 | 9,0 | 27-34 | 25 |
| 2900.M40N | M40x1,5 | 40,5 | 19 -28 | 45 | 50 | 9,0 | 34-42 | 10 |
| 2900.M50N | M50x1,5 | 50,5 | 26 -35 | 54 | 60 | 10,0 | 35-43 | 8 |
| 2900.M63N | M63x1,5 | 64,0 | 34 -45 | 67 | 74 | 15,0 | 40-52 | 5 |

MAXIbrass® reduced cable entry
Metric thread M 1.5 pitch CEI EN 60423 CEI EN 50262

| Ref. Nickel Plated Brass | P | Fixing Hole Ø (mm) | Ø A min-max (mm) | B Spanner (mm) | E (mm) | C (mm) | L min-max (mm) | Quantity |
|--------------------------|---------|--------------------|------------------|----------------|--------|--------|----------------|----------|
| 2910.M12N | M12x1,5 | 12,2 | 1 - 5 | 16 | 18 | 6,5 | 16-20 | 100 |
| 2910.M16N | M16x1,5 | 16,2 | 2,5- 7 | 20 | 23 | 7,0 | 20-25 | 100 |
| 2910.M20N | M20x1,5 | 20,5 | 5 -10 | 24 | 27 | 8,0 | 20-27 | 50 |
| 2910.M25N | M25x1,5 | 25,4 | 6 -13 | 29 | 32 | 8,0 | 24-30 | 50 |
| 2910.M32N | M32x1,5 | 32,5 | 7 -14 | 36 | 40 | 9,0 | 27-34 | 25 |
| 2910.M40N | M40x1,5 | 40,5 | 13 -23 | 45 | 50 | 9,0 | 34-42 | 10 |
| 2910.M50N | M50x1,5 | 50,5 | 20 -29 | 54 | 60 | 10,0 | 35-43 | 8 |
| 2910.M63N | M63x1,5 | 64,0 | 27 -39 | 67 | 74 | 15,0 | 40-52 | 5 |

MAXIbrass® extended thread
Metric thread M 1.5 pitch CEI EN 60423 CEI EN 50262

| Ref. Nickel Plated Brass | P | Fixing Hole Ø (mm) | Ø A min-max (mm) | B Spanner (mm) | E (mm) | C (mm) | L min-max (mm) | Quantity |
|--------------------------|---------|--------------------|------------------|----------------|--------|--------|----------------|----------|
| 2901.M12N | M12x1,5 | 12,2 | 3 - 7 | 16 | 18 | 12 | 16-20 | 100 |
| 2901.M16N | M16x1,5 | 16,2 | 4,5-10 | 20 | 23 | 12 | 20-25 | 100 |
| 2901.M20N | M20x1,5 | 20,5 | 7 -13 | 24 | 27 | 12 | 20-27 | 50 |
| 2901.M25N | M25x1,5 | 25,4 | 10 -17 | 29 | 32 | 12 | 24-30 | 50 |
| 2901.M32N | M32x1,5 | 32,5 | 11 -21 | 36 | 40 | 15 | 27-34 | 25 |
| 2901.M40N | M40x1,5 | 40,5 | 19 -28 | 45 | 50 | 15 | 34-42 | 10 |
| 2901.M50N | M50x1,5 | 50,5 | 26 -35 | 54 | 60 | 15 | 35-43 | 8 |

MAXIbrass® extended thread and reduced cable entry
Metric thread M 1.5 pitch CEI EN 60423 CEI EN 50262

| Ref. Nickel Plated Brass | P | Fixing Hole Ø (mm) | Ø A min-max (mm) | B Spanner (mm) | E (mm) | C (mm) | L min-max (mm) | Quantity |
|--------------------------|---------|--------------------|------------------|----------------|--------|--------|----------------|----------|
| 2911.M12N | M12x1,5 | 12,2 | 1 - 5 | 16 | 18 | 12 | 16-20 | 100 |
| 2911.M16N | M16x1,5 | 16,2 | 2,5- 7 | 20 | 23 | 12 | 20-25 | 100 |
| 2911.M20N | M20x1,5 | 20,5 | 5 -10 | 24 | 27 | 12 | 20-27 | 50 |
| 2911.M25N | M25x1,5 | 25,4 | 6 -13 | 29 | 32 | 12 | 24-30 | 50 |
| 2911.M32N | M32x1,5 | 32,5 | 7 -14 | 36 | 40 | 15 | 27-34 | 25 |
| 2911.M40N | M40x1,5 | 40,5 | 13 -23 | 45 | 50 | 15 | 34-42 | 10 |
| 2911.M50N | M50x1,5 | 50,5 | 20 -29 | 54 | 60 | 15 | 35-43 | 8 |

Cembre SpA

Via Serenissima, 9 - 25135 Brescia (Italy)

Tel.: +39 030 36921 - Fax: +39 030 3365766

Web: www.cembre.com - Email: sales@cembre.com



Prepared by: Marketing dept.

Date: 29/11/2013

**COMPRESSION CABLE GLANDS NICKEL PLATED BRASS
MAXIBRASS 2900 SERIES - METRIC THREAD****Technical details:**

| | | |
|----------------------------|-------------------|----------------------------------|
| PROTECTION : | | IP 68 (EN 60529:1991 / CEI 70-1) |
| MATERIAL : | | CuZn39Pb3 Nickel Plated |
| NICKEL PLATING THICKNESS : | | 2 ÷ 4 µm |
| SEALING RING: | | NEOPRENE® |
| TEMPERATURE RANGE : | | -25°C ÷ +100°C (continuous) |
| CABLE GRIP INSERT : | | POLYAMIDE PA6.6 |
| O-RING : | | Nitrile 70Sh A |
| IMPACT CATEGORY : | M12 | 5 (EN 50262:1999) |
| | M16÷ M63 | 6 (EN 50262:1999) |
| TORQUE SETTINGS : | M12 and M16 | 6 Nm |
| | M20 and M25 | 8 Nm |
| | M32 | 12 Nm |
| | M40 , M50 and M63 | 18 Nm |

Marks:

| | | |
|--|-----------------|--|
|  | VDE: | licence Nos 40008472, 4008474, 40008475 e 40008476 (EN 50262: 1999) |
|  | USL-CNL: | UL LISTING File No E220310; control No 48SB (UL 514B) valid in USA & Canada |
|  | USR-CNR: | USR-CNR: UL RECOGNITION File No E220310 (UL514B) valid in USA & Canada |

Markings: **(EN 50262: 1999)****Cembre SpA**

Via Serenissima, 9 - 25135 Brescia (Italy)
Tel.: +39 030 36921 - Fax: +39 030 3365766
Web: www.cembre.com - Email: sales@cembre.com

Prepared by: Marketing dept.

Date: 29/11/2013