

## MULTI-ENTRY SEAL PLUGS TGM

Pluggin unused entries in multi-entry seals and maintaining IP68.



# MULTI-ENTRY SEAL PLUGS TGM

## *Technical characteristics*

Material (Body)

Polyamide PA6.6

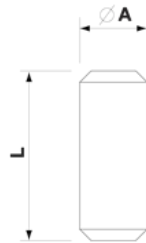

## MULTI-ENTRY SEAL PLUGS TGM

### *List of products*

#### **TGM**



Type	ØA	L	Pack qty	Min. pack qty
TGM38	3 mm	10 mm	5,000	100
TGM48	4 mm	8 mm	5,000	100
TGM58	5 mm	8 mm	5,000	100
TGM513	5 mm	13 mm	2,500	50
TGM613	6 mm	13 mm	2,000	50
TGM713	7 mm	13 mm	2,000	50
TGM817	8 mm	17 mm	100	