

THROUGH CONNECTORS MTMA-GC

for aluminium conductors

MTMA-GC series through connectors are made from aluminium of a purity equal to or greater than 99,5%. They feature a solid stop which creates a barrier between the two sides of conductors to be joined. Barrels are capped and filled with grease so as to avoid oxidation of the connector.



CERTIFICATES 



2011/65/EU

THROUGH CONNECTORS **MTMA-GC**

Technical characteristics

Dimensional form

Through connectors

Material (Body)

Aluminium

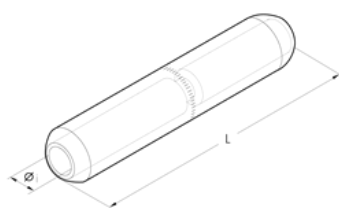

THROUGH CONNECTORS MTMA-GC

List of products

MTMA-GC Cable type: aluminium, Maximum section: 10 mm²



Type	Øi	L	Pack qty	Min. pack qty	Øa
MTMA10-GC	4.3 mm	90.5 mm	60	3	4.3 mm

MTMA-GC Cable type: aluminium, Maximum section: 16 mm²



Type	Øi	L	Pack qty	Min. pack qty	Øa
MTMA16-GC	5.5 mm	90.5 mm	60	3	5.5 mm

MTMA-GC Cable type: aluminium, Maximum section: 25 mm²



Type	Øi	L	Pack qty	Min. pack qty	Øa
MTMA25-GC	6.5 mm	90.5 mm	60	3	6.5 mm

MTMA-GC Cable type: aluminium, Maximum section: 35 mm²



Type	Øi	L	Pack qty	Min. pack qty	Øa
MTMA35-GC	8 mm	90.5 mm	60	3	8 mm
MTMA35-20-GC	8 mm	106.5 mm	30	3	8 mm

MTMA-GC Cable type: aluminium, Maximum section: 50 mm²

Type	Øi	L	Pack qty	Min. pack qty	Øa
MTMA50-GC	9 mm	106.5 mm	30	3	9 mm

MTMA-GC Cable type: aluminium, Maximum section: 70 mm²

Type	Øi	L	Pack qty	Min. pack qty	Øa
MTMA70-GC	11 mm	106.5 mm	30	3	11 mm

MTMA-GC Cable type: aluminium, Maximum section: 95 mm²

Type	Øi	L	Pack qty	Min. pack qty	Øa
MTMA95-GC	12.5 mm	110 mm	30	3	12.5 mm

MTMA-GC Cable type: aluminium, Maximum section: 120 mm²

Type	Øi	L	Pack qty	Min. pack qty	Øa
MTMA120-GC	13.7 mm	133 mm	30	3	13.7 mm

MTMA-GC Cable type: aluminium, Maximum section: 150 mm²

Type	Øi	L	Pack qty	Min. pack qty	Øa
MTMA150-GC	15.5 mm	135 mm	30	3	15.5 mm

MTMA-GC Cable type: aluminium, Maximum section: 185 mm²

Type	Øi	L	Pack qty	Min. pack qty	Øa
MTMA185-GC	17 mm	143.5 mm	15	3	17 mm

MTMA-GC Cable type: aluminium, Maximum section: 240 mm²

Type	Øi	L	Pack qty	Min. pack qty	Øa
MTMA240-GC	19.5 mm	143.5 mm	15	3	19.5 mm

MTMA-GC Cable type: aluminium, Maximum section: 300 mm²

Type	Øi	L	Pack qty	Min. pack qty	Øa
MTMAD300-GC	22.5 mm	144.5 mm	15	3	22.5 mm
MTMA300-GC	23.3 mm	218 mm	15	3	23.3 mm

MTMA-GC Cable type: aluminium, Maximum section: 500 mm²

Type	Øi	L	Pack qty	Min. pack qty	Øa
MTMA500-GC	29.1 mm	218 mm	12	3	29.1 mm