

## TERMINAL BLOCK MARKERS MG-CPM

MG-CPM for terminal block markers Weidmüller, ABB Entelec, Wago, Allen Bradley, Conta-clip, Harting, Morsettitalia, Woertz, Connectwell; are available in versions to suit the particular clip formats of the most widely used products.

Depending on type, markers are presented as joined strips at a set or flexible pitch or as separate markers for convenient individual insertion on mixed pitch terminal block assemblies.

MG-CPM markers provide an elevated mechanical robustness, high dimensional stability and are Halogen free. Printing a complete sheet of MG-CPM markers on MARKINGenius® thermal transfer printers takes around 10 seconds, while to optimise application time, additional data - job details, location, etc - may be printed on the stems. Partused sheets are easily accommodated to avoid wastage.

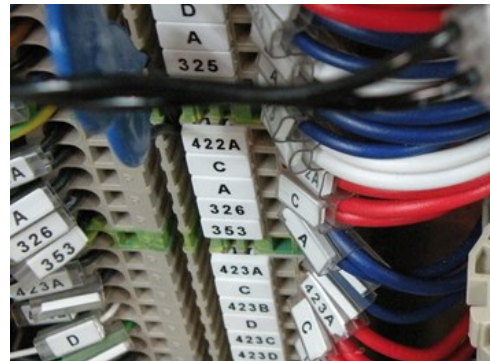

CERTIFICATES 

 2011/65/EU

LABORATORY TEST 

### CEI EN 60950-1

#### INDELIBILITY

#### Information technology equipment - Safety

##### Part 1: General requirements

##### § 1.7.11 Durability

Compliance is checked by inspection and by rubbing the marking by hand for 15 s with a piece of cloth soaked with water and again for 15 s with a piece of cloth soaked with hexane.

After this test, the marking shall be legible; it shall not be possible to remove marking plates easily and they shall show no curling.

### CEI EN 61010-1

#### INDELIBILITY

#### Ed.2 equivalent to VDE 0411-1

#### Safety indications for electric devices for measurement, control and laboratory use

##### Part 1: General indications

This regulation requires that both material and the print shall withstand, cleaning with chemical agents commonly used in industry.

By rubbing manually by hand, without excessive pressure, for 30 seconds with a cloth soaked in the specific detergent or, if not specified, Isopropyl Alcohol.

---

## **CEMBRE STANDARD**

### **INDELIBILITY**

This test was created to simulate cleaning with chemical products commonly used on various surfaces.

By wiping with a cloth soaked in 95% Ethanol 30 times and making a visual inspection after every 10 passes.

---

## **UNI EN ISO 175**

### **EFFECT OF IMMERSION IN LIQUID CHEMICALS**

The standard specifies methods for exposing plastic test samples to liquid chemical agents and for determining changes in characteristics caused by this exposure. It includes the immersion test for 24 hours of the entire surface of the test sample and applies to all solid plastic materials, submitted in the form of printed or extruded materials, plates, pipes, bars or sheets with a thickness greater than 0.1 mm.

The test samples are completely immersed in a test liquid for a specified time and temperature.

Their characteristics are determined before immersion, after removal from the liquid and after drying.

The test methods specified are the following:

- > Changes in mass, dimensions and appearance, immediately after removal from the liquid and after drying
- > Change in the physical characteristics (mechanical, thermal, optical, etc.) immediately after removal from the liquid and after drying
- > The quantity of liquid absorbed

The liquids used by Cembre for this test are: Hydrochloric acid, Nitric acid, Hydrofluoric acid

---

## **DIN 30643**

---

# TERMINAL BLOCK MARKERS MG-CPM

## *Technical characteristics*

Material	Polycarbonate
Halogen Free	yes
Silicon free	yes
UL94 class	V0
Min operating temperature range	-40 °C
Max operating temperature range	130 °C



# TERMINAL BLOCK MARKERS MG-CPM

## List of products

### MG-CPM-01

Geometric shape

rectangular clip with rounded corners

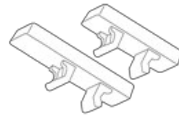

Type	Step of the clamp	Colour	Height	Length	Quantity per sheet	Pack qty	SWcode
MG-CPM-01 41092	3.5 mm	White	3 mm	10 mm	80	2,000	15
MG-CPM-01 41094	5.1 mm	White	5 mm	7 mm	56	1,960	13
MG-CPM-01 41044	5.1 mm	Yellow	5 mm	7 mm	56	1,960	13
MG-CPM-01 41090N	5.1 mm	White	5 mm	10 mm	56	1,960	14
MG-CPM-01 41040N	5.1 mm	Yellow	5 mm	10 mm	56	1,960	14
MG-CPM-01 41091N	5.1 mm	White	5 mm	15 mm	48	1,680	16
MG-CPM-01 41041N	5.1 mm	Yellow	5 mm	15 mm	48	1,680	16
MG-CPM-01 41096	8 mm	White	8 mm	10 mm	32	1.120.00	18
MG-CPM-01 41046	8 mm	Yellow	8 mm	10 mm	32	1.120.00	18

### MG-CPM-02

Geometric shape

rectangular clip with rounded corners

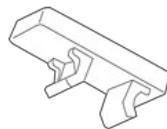

Type	Step of the clamp	Colour	Height	Length	Quantity per sheet	Pack qty	SWcode
MG-CPM-02 41140	8 mm	Yellow	5 mm	10 mm	32	1,120	21
MG-CPM-02 41190N	5.1 mm	White	5 mm	10 mm	48	1,680	22
MG-CPM-02 41140N	5.1 mm	Yellow	5 mm	10 mm	48	1,680	22

### MG-CPM-03

Step of the clamp  
Geometric shape

5 mm  
rectangular clip with rounded corners

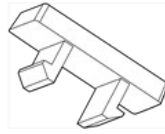

Type	Colour	Height	Length	Quantity per sheet	Pack qty	SWcode
MG-CPM-03 41291	White	5 mm	10 mm	56	1,960	25
MG-CPM-03 41293	White	5 mm	10 mm	56	1,960	25

### MG-CPM-04

Geometric shape

rectangular clip with rounded corners

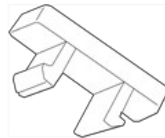

Type	Step of the clamp	Colour	Height	Length	Quantity per sheet	Pack qty	SWcode
MG-CPM-04 41392	3.5 mm	White	3 mm	10 mm	80	2,000	43
MG-CPM-04 41390N	5.2 mm	White	5 mm	10 mm	48	1,680	42
MG-CPM-04 41340N	5.2 mm	Yellow	5 mm	10 mm	48	1,680	42
MG-CPM-04 41395	5.2 mm	White	5 mm	10 mm	48	1,680	31
MG-CPM-04 41391	6 mm	White	6 mm	10 mm	48	1,344	45
MG-CPM-04 41396	8 mm	White	8 mm	10 mm	32	1,120	48
MG-CPM-04 41346	8 mm	Yellow	8 mm	10 mm	32	1,120	48

### MG-CPM-05

Step of the clamp  
Geometric shape

5 mm  
rectangular clip with rounded corners



Type	Colour	Height	Length	Quantity per sheet	Pack qty	SWcode
MG-CPM-05 41495	White	5 mm	8 mm	56	1,960	52
MG-CPM-05 41490	White	5 mm	10 mm	56	1,960	51
MG-CPM-05 41494	White	5 mm	10 mm	56	1,960	51

### MG-CPM-06

Step of the clamp  
Geometric shape

6 mm  
rectangular clip with rounded corners

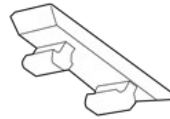

Type	Colour	Height	Length	Quantity per sheet	Pack qty	SWcode
MG-CPM-06 41591	White	5 mm	10 mm	44	1,540	61

### MG-CPM-07

Step of the clamp  
Geometric shape

5.2 mm  
rectangular clip with rounded corners

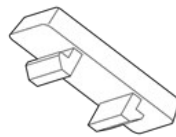

Type	Colour	Height	Length	Quantity per sheet	Pack qty	SWcode
MG-CPM-07 41691	White	5 mm	10 mm	48	1,680	71

### MG-CPM-09

Step of the clamp  
Geometric shape

5+6  
rectangular clip with rounded corners

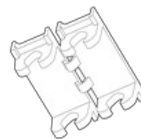

Type	Colour	Height	Length	Quantity per sheet	Pack qty	SWcode
MG-CPM-09 41890	White	5 mm	10 mm	56	1,960	92

### MG-CPM-10

Step of the clamp  
Geometric shape

5.5 mm  
rectangular clip with rounded corners



Type	Colour	Height	Length	Quantity per sheet	Pack qty	SWcode
MG-CPM-10 46192	White	5 mm	12 mm	48	1,680	101
MG-CPM-10 46142	Yellow	5 mm	12 mm	48	1,680	101

## MG-CPM-11

Step of the clamp  
Geometric shape

6.1 mm  
rectangular clip with rounded corners

Type	Colour	Height	Length	Quantity per sheet	Pack qty	SWcode
MG-CPM-11 46342	Yellow	6 mm	12 mm	48	1,344	106
MG-CPM-11 46392	White	6 mm	12 mm	48	1,344	106

## MG-CPM-12

Step of the clamp  
Geometric shape

5÷6  
rectangular clip with rounded corners

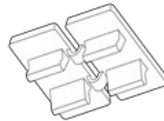

Type	Colour	Height	Length	Quantity per sheet	Pack qty	SWcode
MG-CPM-12 46391	White	4.2 mm	6 mm	56	1,960	111
MG-CPM-12 46390	White	4.2 mm	9 mm	56	1,960	112

## MG-CPM-13

Geometric shape

rectangular clip with rounded corners

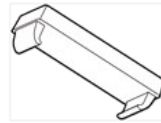

Type	Step of the clamp	Colour	Height	Length	Quantity per sheet	Pack qty	SWcode
MG-CPM-13 41790	5.2 mm	White	5 mm	12 mm	56	1,960	113
MG-CPM-13 41740	5.2 mm	Yellow	5 mm	12 mm	56	1,960	113
MG-CPM-13 41791	6 mm	White	6 mm	12 mm	48	1,680	114
MG-CPM-13 41741	6 mm	Yellow	6 mm	12 mm	48	1,680	114

## MG-CPM-15

Geometric shape

rectangular clip with rounded corners

Type	Step of the clamp	Colour	Height	Length	Quantity per sheet	Pack qty	SWcode
MG-CPM-15 42908	5.1 mm	White	5 mm	5 mm	48	1,680	402
MG-CPM-15 42909	6.1 mm	White	6 mm	5 mm	40	1,400	403