

HYDRAULIC SYSTEMS FOR RAIL WEB ELECTRICAL CONNECTIONS AR...., TYPE

HTEP

System consisting of:

- Hydraulic tool type **HTEP-S**, manually operated.
Head connected to the pumping body through a flexible pipe 900 mm long
- 2 units of plungers **OG 13.2** type in special steel
- type **CAL 19.20** gauge for both check of the rail hole and for screwing of the plunger into the **HTEP-S** tool
- metal case type **VAL HTEP**.



Dimensions:

Pump body:	length	275 mm
	width	130 mm
Head:	length	106 mm
Total weight:		3 kg

RHTEP

System consisting of:

- Hydraulic head type **RHTEP-S** to be connected to a pump developing a nominal pressure of 700 bar
- 2 units of plungers **OG 13.2** type in special steel
- type **CAL 19.20** gauge for both check of the rail hole and for screwing of the plungers itself into the head
- metal case type **VAL RHTEP**



Dimensions:

length:	106 mm
weight:	3 kg

Available upon request:

OG 13.2 T

Plungers OG13.2T composed of 2 separate items: insert and stem. To rapidly execute subsequent extrusion operations, it is sufficient to unscrew the insert, leaving the stem firmly screwed onto the head.

BTEPD2

System composed by:

- Hydraulic portable battery tool with the head directly connected to the body through a 900 mm flexible hose.
- N° 2 calibrated plungers type **OG 13.2** made of special steel
- **CAL 19.20** gauge to use both for checking rail drills and screwing the calibrated plunger to the head.
- Spare battery
- Battery charger
- Wrist strap and shoulder strap
- Canvas bag.



14.4V
3.0Ah
Li-Ion



KIT AR 67 INST

Including:

- **CAL 8.85** Gauge
- **M9 M5** Adapter
- **OG 6.5** Plunger

For the installation of the electrical contact AR 67 type



EXTRACTOR TO REMOVE BUSHES AR 60-1 FROM THE RAILS

ECR 19 + ECR 1 Kits

In order to remove **AR60D** bushes from the rail, available as an optional accessory the **ECR 19** kit (punch + puller) with positioner **ECR-1**. For use please refer to the following picture

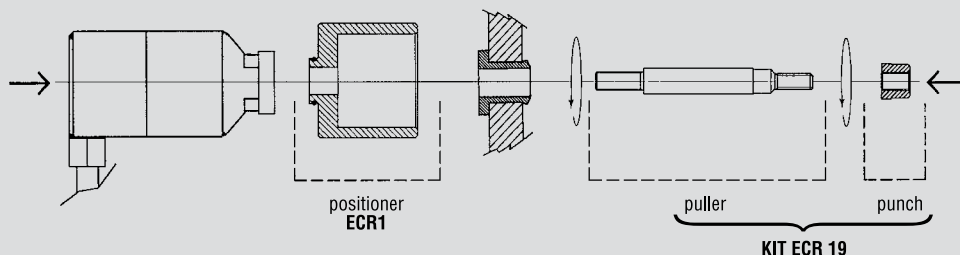

HYDRAULIC NUT SPLITTING HEADS

SINGLE BLADE HEADS

- Requires connection to a pump developing 700 bar pressure
- Lightweight and compact, designed for ease of operation, for a variety of applications.
- The blade can easily be replaced

RHTD 3241

Application field:
suitable for splitting nuts from 32 mm (M 22)
to 41 mm (M 27) hexagon

Working pressure: 700 bar

Weight: 4,6 kg



VAL P4

Supplied in a sturdy plastic case suitable for storing the tool and accessories



DIMENSIONS mm :

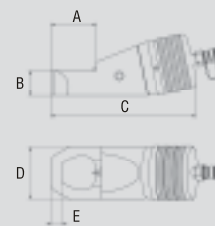

	RHTD 3241	RHTD 1724
A	66	40.5
B	36	25
C	208	150.5
D	75.5	54
E	16	7.5

RHTD 1724

Application field:
suitable for splitting nuts from 17 mm (M 12)
to 24 mm (M 16) hexagon

Working pressure: 700 bar

Weight: 1,76 kg



DOUBLE BLADE HEAD & BATTERY OPERATED UNIT

- Requires connection to a pump developing 700 bar pressure.
- Lightweight and handy; its shape and dimensions have been designed for the best comfort of operation in a variety of applications.
- The blades can be easily replaced in case of damage.
- Supplied in a sturdy plastic case suitable for storing the tool and accessories.



14.4V
3.0Ah
Li-ION



DIMENSIONS mm :

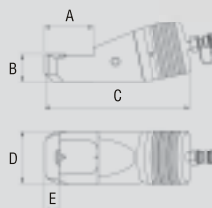

	RHTD 3241T
A	77
B	41
C	222
D	75.5
E	21.5

B-TD3241T

14.4 V battery operated hydraulic tool suitable for splitting fastening bushes, hexagonal and square nuts as per RHTD 3241T.

RHTD 3241T

Application field:
Suitable for splitting square and hexagonal nuts or fastening bushes as indicated in the table below

Working pressure: 700 bar

Weight: 4,9 kg

TOOL SETTING

DOUBLE BLADE (MOVING BLADE AND FIXED BLADE MARKED "B")					SINGLE BLADE (MOVING BLADE MARKED "B" - BLIND PLATE MARKED "C")										
HEXAGONAL NUTS		SQUARE NUTS		FASTENING BUSHES		HEXAGONAL NUTS		SQUARE NUTS							
	mm		Ø		mm		Ø		mm		Ø		mm		Ø
27	M 18	27	M 18	1/2"	0.807"	32	M 22	32	M 22						
30	M 20	30	M 20	5/8"	1.010"	34	M 22	36	M 24						
32	M 22	32	M 22	3/4"	1.200"	36	M 24	41	M 27						
34	M 22	36	M 24	7/8"	1.375"	41	M 27								
36	M 24	41	M 27	1"	1.575"										
41	M 27			1 1/8"	1.770"										

* Blades for cutting FASTENING BUSHES are specially shaped